

CITY OF ARMADALE

AGENDA

OF TECHNICAL SERVICES COMMITTEE TO BE HELD IN THE COMMITTEE ROOM, ADMINISTRATION CENTRE, 7 ORCHARD AVENUE, ARMADALE ON MONDAY, 1 FEBRUARY 2016 AT 7:00PM.

A meal will be served at 6:15 p.m.

PRESENT:

APOLOGIES: Cr J A Stewart (Leave of Absence)

OBSERVERS:

IN ATTENDANCE:

PUBLIC:

“For details of Councillor Membership on this Committee, please refer to the City’s website – www.armadale.wa.gov.au/your_council/councillors.”

DISCLAIMER

The Disclaimer for protecting Councillors and staff from liability of information and advice given at Committee meetings to be read.

DECLARATION OF MEMBERS' INTERESTS

QUESTION TIME

DEPUTATION

CONFIRMATION OF MINUTES

RECOMMEND

**Minutes of the Technical Services Committee Meeting held on 7 December 2015
be confirmed (*Meeting scheduled for 18 January 2016 cancelled*).**

ITEMS REFERRED FROM INFORMATION BULLETIN

The following items were referred via Issue No 01/2016:

- **Outstanding Matters and Information Items**
Various ItemsT-1
- **Monthly Departmental Reports**
Technical Services Works ProgrammeT-2

If any of the items listed above require clarification or a report for a decision of Council, this item to be raised for discussion at this juncture.

CONTENTS

TECHNICAL SERVICES COMMITTEE

1 FEBRUARY 2016

1. PRESENTATIONS	
1.1 2015 GROUNDWATER USE REPORT.....	4
2. ENGINEERING ADMINISTRATION	
2.1 ROAD CLOSURE - PORTION OF ALLEN ROAD	5
3. ENGINEERING, DESIGN AND DEVELOPMENT	
3.1 PETITION - INSTALLATION OF FOOTPATHS WITHIN LAKE WARD	10
4. PARKS AND RESERVES	
4.1 CONFERENCE ATTENDANCE - ARBORICULTURE AUSTRALIA - 2 ND INTERNATIONAL CONFERENCE ON URBAN TREE DIVERSITY - MELBOURNE 19-24 FEBRUARY 2016	14
5. TENDERS	
5.1 TENDER NO 25/15 - SUPPLY OF HIRED PLANT - WET HIRE OF EXCAVATORS	18
6. MISCELLANEOUS	
6.1 CITY BUILDINGS - MAINTENANCE STANDARDS.....	23
7. COUNCILLORS' ITEMS	
NIL	24
8. EXECUTIVE DIRECTOR TECHNICAL SERVICES REPORT	
NIL	24
SUMMARY OF "A" ATTACHMENTS.....	25

1.1 - 2015 GROUNDWATER USE REPORT

A presentation will be made by the Manager Parks in relation to the 2014-2015 Groundwater Use Report detailed in Info Bulletin Issue No 20/2015, dated November 2015. As raised in discussion at the Technical Services Committee Meeting of Monday, 7 December 2015, the importance and complexity of the subject matter, determined that a presentation to Councillors would be beneficial.

ATTACHMENTS

There are no attachments for this report.

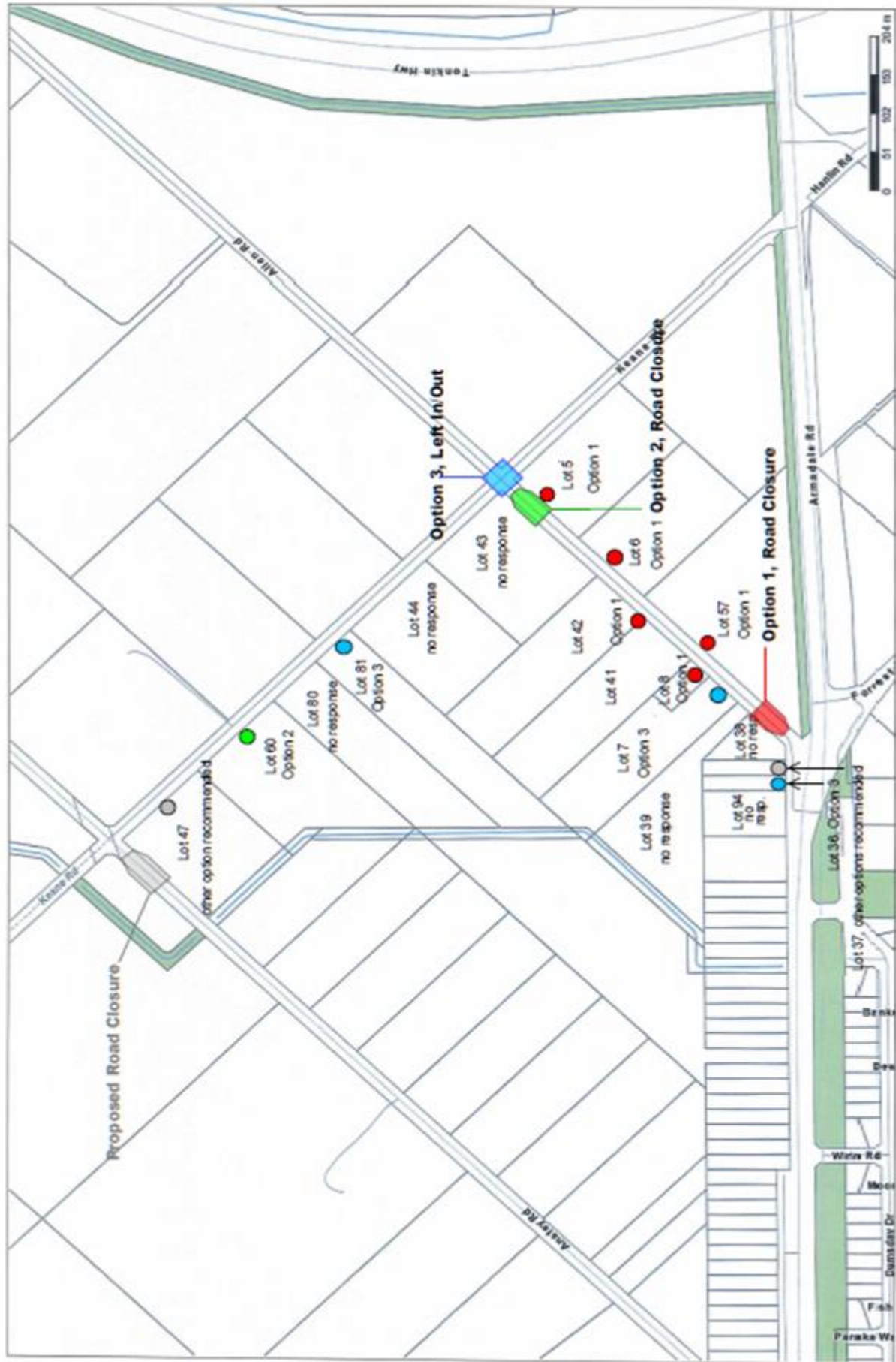

2.1 - ROAD CLOSURE - PORTION OF ALLEN ROAD

WARD : LAKE
FILE No. : M/1118/15
DATE : 1 December 2015
REF : JA
RESPONSIBLE : Executive Director
MANAGER : Technical Services

In Brief:

- The proposed development of Forrestdale Business Park West (FBPW) by the Metropolitan Redevelopment Authority (MRA) provides for the closure of Anstey Road as a through road, between Armadale Road and Ranford Road.
- This would result in the likelihood of heavy traffic using Allen Road as a thoroughfare between Armadale Road and Keane Road in order to access FBPW and Ranford Road.
- This would require the closure of Allen Road, between Armadale Road and Keane Road, to prevent “rat-running” through this residential area.
- Landowners in the area were canvassed as to the most suitable method, and most appropriate location, for the proposed closure of Allen Road.
- The responses identified the closing of Allen Road, near Armadale Road, as the most suitable option.
- **Recommend:**

That Council close Allen Road near Armadale Road to through traffic, and proceed with the required local public notice process.

Tabled Items

Nil.

Officer Interest Declaration

Nil.

Strategic Implications

2. Enhanced Natural and Built Environments
 - 2.5 Safe and efficient movement of goods, services, and people.
 - 2.5.1 Provide a safe and efficient movement network, including local and arterial roads, and associated infrastructure.

Legislation Implications

Assessment of legislation indicates that the following apply:

- Local Government Act 1995: Part 3 – Functions of Local Governments, Subdivision 5 – Certain provisions about thoroughfares; Clause 3.50 - Closing Certain Thoroughfares to Vehicles.

Council Policy/Local Law Implications

General assessment has not revealed any applicable Policies/Local Laws.

Budget/Financial Implications

The adoption of the recommendation contained in this report has no financial implication.

Consultation

- Intra Directorate.

BACKGROUND

As part of the Forrestdale Business Park West (FBPW) development, the Metropolitan Redevelopment Authority (MRA) will be closing Anstey Road, between Armadale Road and Keane Road. This closure is at the City's request to prevent heavy traffic from traversing through FBPW via the residential section of Anstey Road.

Concerns were raised that the proposed closure of Anstey Road could provide heavy traffic with the opportunity to use Allen Road as a thoroughfare when the Business Park is completed. It was therefore determined that some form of traffic management, with closure a primary recommendation, would be required to prevent through traffic using this route.

Consequently, in order to obtain community feedback, and to assist the City in establishing the most acceptable method and location for road closure, landowners in the area were invited to complete a questionnaire regarding closure of portions of Allen Road.

The responses to the questionnaire demonstrated that the majority of landowners identified the closure of Allen Road, near Armadale Road, as the most suitable option.

COMMENT

The questionnaire was posted to landowners on Friday, 30 October 2015, with a submission closure date of Monday, 23 November 2015.

Options

The questionnaire suggested three options as demonstrated diagrammatically below:

1. Closing Allen Road near Armadale Road;
2. Closing Allen Road near Keane Road; or
3. Modifying the intersection of Keane Road/Allen Road to allow left in/out traffic only.

Option 1 – Closing Allen Rd near Armadale

Option 2 – Closing Allen Rd near Keane Rd

Option 3 – Left In/Out

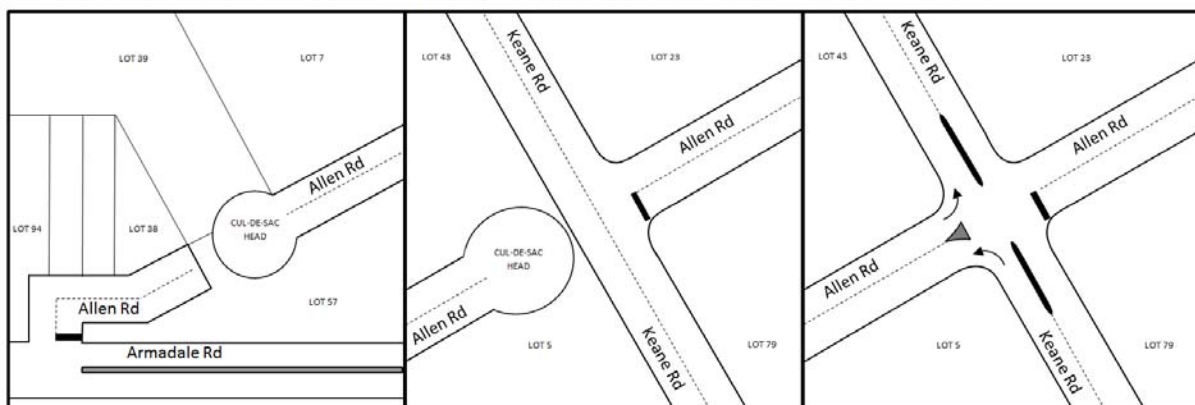

Analysis

Sixteen (16) landowners were invited to complete the questionnaire, with eleven (11) responses received by the closing date.

The ranking of the three suggested options is as follows:

Rank	Option		Votes	Vote %
1	1	Closing Allen Road near Armadale Road	5	46%
2	3	Left In/Out	3	27%
3	2	Closing Allen Road near Keane Road	1	9%
	Other		2	18%
Total			11	100%

Option 1 – Closing of Allen Road near Armadale Road received the highest score and was viewed by the majority of landowners residing in Allen Road as the most suitable method and location for road closure.

Option 2 – Closing of Allen Road near Keane Road received the lowest score, with the landowner complaining that residents in the area had no voice when the decision was made to change the area classification from special rural to industrial.

Option 3 – Modifying the intersection of Keane Road/Allen Road to allow left in/out traffic only received the second highest score, with landowners reporting that there was a road closure at Allen Road many years ago. Some voters of this option also recommended the installation of speed limit signs or speed humps to calm traffic.

Other options suggested by respondents include:

- The closure of Allen Road north east of Keane Road: This proposal is considered inappropriate as it would prevent traffic on Keane Road from accessing the Business Park via Allen Road.
- The installation of speed humps and “local traffic only” signs at Allen Road: This proposal is considered as insufficient as it will not hinder the passage of vehicles to the Business Park using Allen Road as a thoroughfare, especially when the proposed traffic lights at the intersection of Armadale Road/Keane Road are implemented.

CONCLUSION

A questionnaire was issued in order to obtain feedback, and to assist the City in establishing the most suitable method and location for road closure and construction of cul-de-sac heads on Allen Road, between Armadale Road and Keane Road.

Council invited sixteen (16) landowners to provide responses about the closure of a portion of Allen Road, receiving eleven (11) replies identifying the closing of Allen Road near Armadale Road as the preferred option. This preferred option is supported by the City’s Technical Officers. It is therefore recommended to provide a cul-de-sac on Allen Road, near Armadale Road.

RECOMMEND

That Council:

1. **Approves the closure of Allen Road to through traffic at a suitable point close to the Armadale Road intersection.**
2. **Authorises the commencement of the necessary local public notice processes to allow the proposed closure to be implemented.**

ATTACHMENTS

There are no attachments for this report.

3.1 - PETITION - INSTALLATION OF FOOTPATHS WITHIN LAKE WARD

WARD : LAKE
FILE No. : M/11/16
DATE : 12 January 2016
REF : SA
RESPONSIBLE : Executive Director
MANAGER : Technical Services

In Brief:

- A petition was presented at the Ordinary Council Meeting of 23 November 2015, the prayer of which requested that various footpaths be installed in the vicinity of Angelo Street.
- The requested paths have been assessed in relation to the Armadale Path Network Development Plan – Skeletal Path Plan Stage 2.

▪ **Recommend:**

That Council:

1. Note the inclusion of Angelo Street in the Armadale Path Network Development Plan - Skeletal Path Plan – Stage 2.
2. Note that the three additional paths requested have not been included in the Armadale Path Network Development Plan - Skeletal Path Plan – Stage 2.

Tabled Items

Nil.

Officer Interest Declaration

Nil.

Strategic Implications

2. Enhanced Natural and Built Environments
 - 2.5 Safe and efficient movement of goods, services, and people.
 - 2.5.1 Provide a safe and efficient movement network, including local and arterial roads, and associated infrastructure.
 - 2.5.2 Implement pathway strategies in accordance with community needs.

Legislation Implications

General assessment of relevant legislation (eg Local Government Act) has not revealed any restrictions).

Council Policy/Local Law Implications

Assessment of Policy/Local Law indicates that the following are applicable:

- Local Law Relating to Parking Facilities.

Budget/Financial Implications

The adoption of the recommendation contained in this report has no financial implication.

Consultation

- Intra Directorate.

BACKGROUND

At the Ordinary Meeting of 21 December 2015, Council resolved as follows in relation to a petition requesting the installation of a number of footpaths in Lake Ward, in the vicinity of Angelo Street:

482/12/15 *“That following investigation, a further report be presented to the Technical Services Committee Meeting of February 2016, addressing the request for various footpaths.”*

A full assessment has been carried out, with background, comment and recommendation outlined within the body of this report.

DETAILS OF PROPOSAL

The petition lists the following roads, as those that the signatories request new paths be installed:

- Angelo Street.
- Grealis Street.
- Townsend Street.
- Werndley Street.

Council approved the Skeletal Path Plan Stage 2, which was finalised in October 2015. This document is used as the current basis for prioritising new footpaths within the City. The assessment process for footpaths was recently forwarded to Councillors for information, and the assessment criteria are well explained in the document provided.

Presently there are 104 sections of new paths listed in the Skeletal Path Plan Stage 2, which will be completed in coming years, depending on budgetary allocations.

The Skeletal Path Plan Stage 2 includes the section of Angelo Street between Seventh Road and Egan Street. The three remaining roads requested in the petition are not included as they were not assessed as having sufficient priority compared to other roads in the vicinity.

Attached to this report is an extract (plan) taken from the Skeletal Path Plan Stage 2 for the immediate area around the requested paths, where it is shown that Angelo Street is included, ie shown in green. It should be noted that those sections of road shown in red indicate an existing path. It can be seen that Angelo Street provides a vehicular link from Seventh Road to Egan Street, whereas the three other roads, namely Grealis Street, Townsend Street, and Werndley Street, provide lesser connectivity.

Angelo Street is currently ranked 54 on the Skeletal Path Plan Stage 2, which based on present Annual Budget allocations, should result in this section of path being installed within the next three to five years.

CONCLUSION

An assessment of the pathways listed in the petition indicates that only Angelo Street meets the requirements for inclusion, and that the other three roads fail to meet the requirements adequately.

As such, it is recommended that Council advise the convenor of the petition that only Angelo Street is currently listed within the City's Skeletal Path Plan Stage 2, and that the other three roads are to remain unlisted due to low assessment rankings.

RECOMMEND

That Council:

- 1. Note that Angelo Street is already included in the Armadale Path Network Development Plan - Skeletal Path Plan – Stage 2, with a likelihood that construction would be possible in approximately three to five years.**
- 2. Note that the footpaths on:**
 - Grealis Street;**
 - Townsend Street; and**
 - Werndley Street;**

have not been included in the Armadale Path Network Development Plan - Skeletal Path Plan – Stage 2, and will be reassessed for inclusion in Stage 3 of the Skeletal Path Plan when this is compiled at the conclusion of Stage 2.

- 3. Inform the petition convenor of (1) and (2) above.**

ATTACHMENTS

1. Skeletal Path Plan - Stage 2.

**4.1 - CONFERENCE ATTENDANCE - ARBORICULTURE AUSTRALIA - 2ND
INTERNATIONAL CONFERENCE ON URBAN TREE DIVERSITY - MELBOURNE
19-24 FEBRUARY 2016**

WARD : ALL
FILE No. : M/1/16
DATE : 6 January 2016
REF : LG/KK/MS
RESPONSIBLE : Executive Director
MANAGER : Technical Services

In Brief:

- The Arboriculture Australia 2nd International Conference on Urban Tree Diversity is to be held in Melbourne, Victoria, from 19-24 February 2016.

▪ **Recommend:**

That Council:

1. Nominate Councillor as a delegate to the Arboriculture Australia 2nd International Conference on Urban Tree Diversity, to be held in Melbourne, Victoria, from 19-24 February 2016.

*Or should no nomination be received,
then the recommendation is as follows:*

No nomination is made for attendance at Arboriculture Australia 2nd International Conference on Urban Tree Diversity, to be held in Melbourne, Victoria, from 19-24 February 2016.

2. Note the attendance of a Senior Officer from Technical Services as delegate to the Arboriculture Australia 2nd International Conference on Urban Tree Diversity, to be held in Melbourne, Victoria, from 19-24 February 2016.

Tabled Items

Nil.

Officer Interest Declaration

Nil.

Strategic Implications

2. Enhanced Natural and Built Environments
 - 2.4 Attractive and user friendly streetscapes and open space.
 - 2.4.1 Implement townscape, streetscape, and parkland improvements, to enhance the distinctive character of the City.
 - 2.4.2 Maintain and improve where required, the quality, amenity and accessibility of open spaces.
 - 2.8 A natural environment and bushland that is sustained, enhanced and strengthened.
 - 2.8.1 Develop an appropriate policy and long term works programs to protect and enhance our bushland and natural environs under the City's control.
 - 2.8.2 Provide natural area maintenance and management programs.
 - 2.8.3 Advocate and support management plans and initiatives to improve waterways and natural areas within the City.

Legislation Implications

General assessment of relevant legislation (eg Local Government Act) has not revealed any restrictions).

Council Policy/Local Law Implications

Assessment of Policy/Local Law indicates that the following are applicable:

- Council Policy ADM3 – Conferences and Training.
- Council Policy EM1 – Reimbursement of Councillor's Expenses.

Budget/Financial Implications

Costs can be contained within the 2015/2016 Budget allocation.

Consultation

- Intra Directorate.

BACKGROUND

The Arboriculture Australia 2nd International Conference on Urban Tree Diversity is to be held in Melbourne, Victoria, from 19-24 February 2016.

The Conference seeks to present innovative ideas, emerging trends, and current issues affecting parks professionals. This year's Conference will involve a number of workshops, trade exhibitions and presentations delivered by industry leaders.

COMMENT

This international conference brings together leading researchers and practitioners to discuss aspects of urban tree diversity from around the world, with the aim of assessing research, and promoting the development of good practice and innovative approach to urban tree planning and management. The Conference is interdisciplinary, and will engage urban tree professionals working within both the public and private sectors.

Urban trees are central to providing healthy, vibrant and attractive cities throughout the world. They provide a wide range of ecosystem services, from mitigating the effects of climate change, to providing a sense of place.

Diversity within urban tree populations can increase overall resilience to drought, heatwaves, storms, and the rise of pests and disease. Such challenges call for the selection of appropriate tree species, and the design and implementation of novel urban tree management strategies to enhance diversity and resilience.

Prominent keynote speakers for the Conference are:

- Susan D Day – Associate Professor - Virginia Tech.
- Diane Pataki – Associate Professor, Biology – University of Utah.
- C Y Jim – Chair Professor of Geography, Leader of Urban Ecology Research Group – Hong Kong University.
- Cecil Konijnendijk van den Bosch – Head of the Department of Landscape Architecture, Planning and Management – SLU Sweden.
- Anne Jaluzot – Experience professional urban planner specializing in green infrastructure and sustainable urban design.

The City of Armadale has a vast urban forest, and this is a major reason why people choose to live in the City. However, this asset is increasingly coming under threat from development, and as a result in 2014 Armadale was one of the first Western Australian Councils to develop an Urban Forest Strategy, identifying what needs to be done to protect and enhance this green infrastructure.

The Urban Forest Strategy places a special emphasis on the need for collaboration between the City and its residents. Experience elsewhere has shown that a sense of community ownership of the urban forest contributes greatly to its perceived value. Urban forests of course have a great value environmentally, socially and economically. It also takes into account existing planning strategies, and makes suggestions that will inform future planning models. Management of the City's urban forest is a large, complex and costly responsibility.

The City of Armadale's Urban Forest Strategy document will continue to evolve and be improved as the City grows, and as new pressures and opportunities arise. It is an important first step towards ensuring that trees become an integral part of the City's planning processes, and that the City remains at the forefront of the latest information as industry leaders.

Attendance at a Conference such as the Arboriculture Australia 2nd International Conference on Urban Tree Diversity is vital in gaining a truly collaborative approach in the ongoing development of the City's Urban Forest Strategy, and the delivery of a vision of a healthy, resilient and diverse urban forest that contributes to the health and wellbeing of the City's communities by creating better environments for all.

CONCLUSION

The Arboriculture Australia 2nd International Conference on Urban Tree Diversity offers items of significant interest to the Local Government sector, and will be represented by Local Government Officers, other government agencies, consultants and students. It is considered that the Conference will provide an important and informative interface to the professional development and management of the City's streetscapes, public open space, parks and reserves.

RECOMMEND

That Council:

1. **Nominate Councillor as a delegate to the Arboriculture Australia 2nd International Conference on Urban Tree Diversity, to be held in Melbourne, Victoria, from 19-24 February 2016.**

Or should no nomination be received, then the recommendation is as follows:

No nomination is made for attendance at Arboriculture Australia 2nd International Conference on Urban Tree Diversity, to be held in Melbourne, Victoria, from 19-24 February 2016.

2. **Note the attendance of a Senior Officer from Technical Services as delegate to the Arboriculture Australia 2nd International Conference on Urban Tree Diversity, to be held in Melbourne, Victoria, from 19-24 February 2016.**

ATTACHMENTS

There are no attachments for this report.

5.1 - TENDER NO 25/15 - SUPPLY OF HIRED PLANT - WET HIRE OF EXCAVATORS

WARD : ALL
FILE No. : M/972/15
DATE : 15 January 2016
REF : JR
RESPONSIBLE : Executive Director
MANAGER : Technical Services

In Brief:

- Tender No 25/15 was recently called for the Supply of Hired Plant - Wet Hire of Excavators, for Civil Works projects within the City of Armadale.
- The Request for Tender seeks the provision of the required services for a period of twelve (12) months, with an option to extend for a further two (2) periods of twelve (12) months.

▪ **Recommend:**

That with Tender No 25/15 for the Supply of Hired Plant – Wet Hire of Excavators, that Council:

1. Accepts the tender from Aussie Earthworks for an initial period of twelve (12) months, commencing 1 March 2016, in accordance with the submitted tender, Council contract documentation, and Budget allocation.
2. Authorise the Chief Executive Officer to extend the contract for two (2) periods of twelve (12) months up to 28 February 2019, subject to satisfactory performance by the contractor and price adjustments as specified in the Request for Tender document, Clause 4.1.

Tabled Items

Nil.

Officer Interest Declaration

Nil.

Strategic Implications

2. Enhance Natural and Built Environments.
 - 2.5 Safe and efficient movement of goods, services and people.
 - 2.5.1 Provide a safe and efficient movement network, including local and arterial roads and associated infrastructure.

Legislation Implications

Assessment of legislation indicates that the following apply:

- Local Government Act 1995: Section 3.57 – Tenders for Providing Goods or Services.
- Local Government (Functions and General Regulations) 1996: Division 2 – Tenders for Providing Goods or Services.

Council Policy/Local Law Implications

Assessment of Policy/Local Law indicates that the following are applicable:

- Council Policy ADM 19 – Procurement of Goods or Services.

Budget/Financial Implications

Works can be accommodated within the 2015/2016 Civil Works Budget.

Consultation

- Intra Directorate.
- Inter Directorate.
- Governance and Administration.

BACKGROUND

Tender No 25/15 for the Supply of Hired Plant – Wet Hire of Excavators was advertised in the Saturday, 19 September 2015, edition of 'The West Australian' newspaper, and in a notice which was displayed on the Administration Centre, Armadale, Kelmscott, and Seville Grove Libraries' public notice boards.

The tender calls for the wet hire (ie machine with operator) of various types of machinery, which are used extensively in various roles within Civil Works operations.

DETAILS OF PROPOSAL

For the purpose of the tender, the City requires the hire services of the following types of machinery, with qualified operators:

- Track type excavators between 1.5T and 36T, occasionally with rock breaker attachment.
- Rubber tyre type excavators between 5.5T and 14T, licensed for road use, occasionally with rock breaker attachment.
- Loaders.
- Backhoes (only occasionally).
- Watercarts (only occasionally).
- Trucks (only occasionally).
- Dozers (only occasionally).
- Rollers (only occasionally, but without operators).

DETAILS OF NEW CONTRACT

Contract Type	Schedule of Rates
Initial Contract Duration	12 Months
Commencement Date	1 March 2016
Expiry Date	28 February 2017
Extension Permitted	Yes - As per Request for Tender Clause 4.1 Two (2) x 12 Month Extensions to 28 Feb 2019
Initial Contract Cost (12 months)	\$180,000 including GST (Approximately)
Total Contract Cost (36 months)	\$540,000 including GST (Approximately)
Rise and Fall Clause Included	Fixed for the first term

COMMENT

Analysis

Tender No 25/15 for the Supply of Hired Plant - Wet Hire of Excavators, closed at 2:00pm on Wednesday, 7 October 2015.

Tenderer's OR Respondent's Name	
1.	Allwest Plant Hire
2.	Fencing and Machinery Hire (JCB)
3.	HAS Earthmoving
4.	Mayday Earthmoving
5.	Terravac Vacuum Excavation
6.	Trenchbusters Plant Hire
7.	Mining and Drilling Services Pty Ltd
8.	Aussie Earthworks Pty Ltd
9.	Brooks Hire
10.	Giumelli Earthworks Pty Ltd
11.	Maintenance and Construction Services (Australia) Pty Ltd
12.	Paramount Earthmoving Pty Ltd

No tenders were received after the close of deadline, and one (1) non-conforming tender was received from Terravac Vacuum Excavation. The assessment of the tender from Terravac Vacuum Excavation has therefore not been included in this report.

An evaluation process was undertaken, having specific regard to the following criteria:

- 60% - Price.
- 10% - Relevant Experience.
- 10% - Key Personnel Skills and Experience.
- 10% - Tenderer's Resources.
- 10% - Demonstrated Understanding.

Assessment

The tender submissions have been assessed and rated, with the outcome as detailed below:

Tender	Relevant Experience	Key Personal	Tender's Resources	Demonstrated Understanding	Price	Overall Total	Ranking
	10%	10%	10%	10%	60%	100%	
Aussie Earthworks Pty Ltd	6.19%	4.92%	7.00%	6.75%	60.00%	84.86%	1
Allwest Plant Hire	8.00%	7.75%	7.88%	7.75%	46.69%	78.07%	2
Fencing and Machinery Hire (JCB)	4.94%	6.08%	6.50%	5.00%	49.29%	71.81%	3
HAS Earthmoving	6.50%	5.75%	6.88%	7.50%	39.02%	65.65%	4
Mayday Earthmoving	3.88%	4.67%	5.38%	2.75%	47.37%	64.05%	5
Mining and Drilling Services Pty Ltd	5.25%	6.42%	6.69%	5.75%	30.89%	55.00%	6
Trenchbusters Plant Hire	4.56%	5.50%	6.19%	6.00%	32.34%	54.59%	7
Brooks Hire	2.00%	3.33%	6.56%	4.75%	37.46%	54.10%	8
Paramount Earthmoving Pty Ltd	4.25%	4.00%	4.75%	3.38%	35.27%	51.65%	9
Guimelli Earthworks Pty Ltd	3.13%	3.58%	3.44%	3.63%	21.78%	35.56%	10
Maintenance and Construction Services (Australia) Pty Ltd	2.13%	3.75%	3.13%	5.00%	14.42%	28.43%	11

Based on the Panel's evaluation, the submission from Aussie Earthworks represents the best value for money, and most advantageous submission for the City of Armadale.

Aussie Earthworks has provided a similar plant hire service over a number of years to the City of Armadale. Aussie Earthworks are a locally based City of Armadale contractor. It is therefore recommended that Aussie Earthworks be awarded Tender No 25/15 for the Supply of Hired Plant - Wet Hire of Excavators.

CONCLUSION

Tender No 25/15 for the Supply of Hired Plant - Wet Hire of Excavators, was recently invited with eleven (11) conforming tenders being received and assessed against compliance, qualitative criteria, and price.

As a result, the submission received from Aussie Earthworks is considered to be the most advantageous tender for the City of Armadale. The Evaluation Panel therefore recommends that the contract be awarded to Aussie Earthworks, for an initial period of twelve (12) months, with an option to extend for a further two (2) periods of twelve (12) months.

RECOMMEND

That with Tender No 25/15 for the Supply of Hired Plant – Wet Hire of Excavators, that Council:

- 1. Accepts the tender from Aussie Earthworks for an initial period of twelve (12) months, commencing 1 March 2016, in accordance with the submitted tender, Council contract documentation, and Budget allocation.**
- 2. Authorise the Chief Executive Officer to extend the contract for two (2) periods of twelve (12) months up to 28 February 2019, subject to satisfactory performance by the contractor and price adjustments as specified in the Request for Tender document, Clause 4.1.**

ATTACHMENTS

There are no attachments for this report.

6.1 - CITY BUILDINGS - MAINTENANCE STANDARDS

At the Ordinary Council Meeting of Monday, 21 December 2015, Cr C Wielinga referred the following matter to the Technical Services Committee:

“That the matter of maintenance standards of Council Buildings be referred to the Technical Services Committee.”

Comment from Cr C Wielinga

Cr Wielinga advised that her observation was that the amenity of some City buildings and equipment contained within could be improved, questioning the need for additional funds to be made available for this purpose.

Officer Comment

Nil.

RECOMMEND:

To be determined.

ATTACHMENTS

There are no attachments for this report.

COUNCILLORS' ITEMS

Nil

EXECUTIVE DIRECTOR TECHNICAL SERVICES REPORT

Nil

MEETING DECLARED CLOSED AT _____

TECHNICAL SERVICES COMMITTEE		
SUMMARY OF "A" ATTACHMENTS		
1 FEBRUARY 2016		
ATT NO.	SUBJECT	PAGE
3.1 PETITION - INSTALLATION OF FOOTPATHS WITHIN LAKE WARD		
3.1.1	Skeletal Path Plan - Stage 2.	27

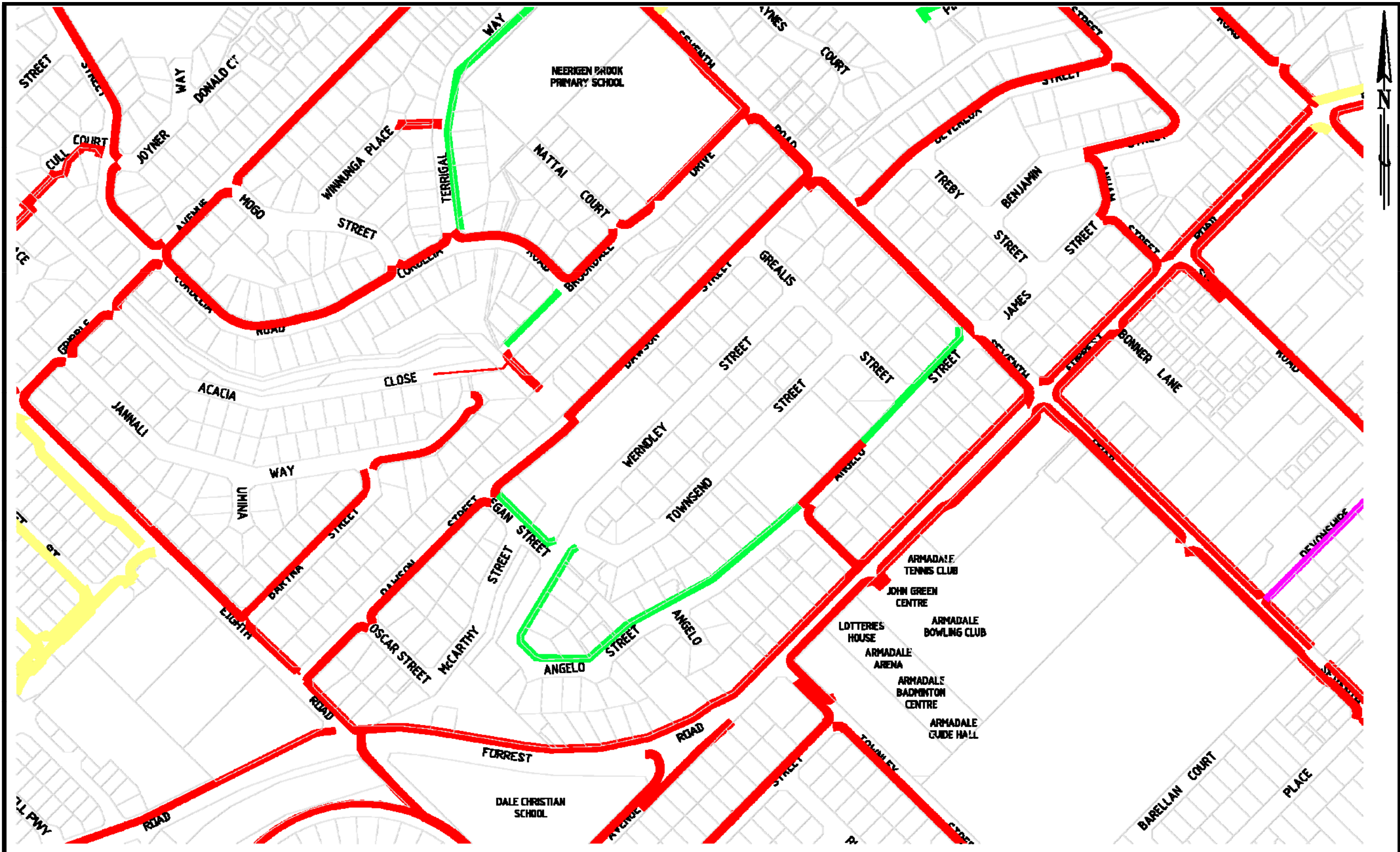

LEGEND:

	COMPLETED		CONCRETE FOOTPATH 2m IN WIDTH OR MORE
	UNCONSTRUCTED PATHS ON SKELETAL PLAN STAGE 1		RED ASPHALT FOOTPATH 2m IN WIDTH OR MORE
	PROPOSED SKELETAL PLAN STAGE 2		
	CASH IN LIEU FUNDED OR SUBDIVIDER TO PROVIDE		

CITY OF ARMADALE SKELETAL PATH PLAN

CAD FILE 2016-01-19 Proposed skeletal 2 as at December 2015.dwg	
DRAWING STATUS SKETCH	SHEET 01 of 01
PLAN No. SK-01	AMENDMENT 0